



KARMAN
BE YOURSELF



PLASTIKARMAN

C'è un mondo di plastica in mezzo a noi: ci avvolge, ci racchiude.

È una realtà dai contorni indefiniti, sfocati, strappati.

Secoli di progresso, vissuti nella convinzione del benessere ad ogni costo e nella visione grottesca dell'usa e getta, stanno mettendo a repentaglio la vita stessa su questo pianeta.

La metamorfosi evolutiva si è arrestata: l'essere primitivo, adorno di pelli, archetipo di un universo tanto lontano dalle nostre abitudini, idealmente si ricongiunge a noi, come in un cerchio che si chiude.

Vestiti, non di pelli ma di plastica, con le fragilità e quel caparbio istinto di sopravvivenza, ci confrontiamo col nostro passato e scopriamo, con sgomento, di essere regrediti al punto d'inizio, come se millenni di sviluppo non ci avessero portato a nulla.

Soli, con le nostre nudità e le nostre piccole convinzioni, come l'essere di un tempo remoto, costretto entro la propria dimora di fortuna, siamo aggrappati a ciò che più ci rassicura, al calore vitale di un ipotetico fuoco, ad una luce salvifica.

Da quella luce, metaforica o reale che sia, dobbiamo ripartire, per ricostruire una visione differente della vita: possibilmente liberi da fuorvianti modelli di sviluppo e dalla plastica.

Noi di Karman ci stiamo lavorando.

We're living submerged in a world of plastic: it wraps itself around us, closing us in.

It's a reality with undefined, out-of-focus, torn boundaries.

Centuries of progress, lived in the belief that human wellbeing is paramount, whatever the cost, and in the grotesque vision of throwaway culture, are jeopardising the very life of this planet.

Our evolutionary metamorphosis has stopped: the primitive being, covered in skins, the archetype of a universe light years from our own lifestyle is ideally catching up with us again, coming full circle.

Dressed, not in skins but in plastic, and accompanied by that stubborn survival instinct and our fragilities, faced with our past, we are dismayed to find that we've regressed to the starting point, as if thousands of years of development had led to nothing.

Alone, with our vulnerabilities and paltry beliefs, like those beings from long ago, confined in our makeshift home, we cling to the force that reassures us most, to the vital warmth of a hypothetical fire, to a light that will be our salvation.

We must start again from that light, whether metaphorical or real, and rebuild a different vision of life: a life - if possible - free from misleading development models, and from plastic.

Here at Karman, we're working on it.



INDICE / INDEX

1. POIS	pag. 6
2. ABACHINA	20
3. LEDA	36
4. AGUA	54





3.

4.

1.

2.

4.

POIS

design matteo ugolini

Dalle stampe su pregiati tessuti alla decorazione dello spazio esterno, fluttuando tra sfondi di suggestive architetture e quelle più pittoriche della natura, Pois di luce si mimetizzano come lucciole nel giardino e fanno capolino tra i cespugli.

From fine fabric prints to outdoor decor, floating against backdrops of striking architecture or colourful nature, the Pois light camouflages itself like a firefly in the garden, peeping through the bushes.







POIS
design
matteo ugolini







POIS
design
matteo ugolini



POIS

design
matteo ugolini

Struttura - alluminio nero opaco
Structure - matt black aluminum
Diffusore - resina bianca
Shade - white resin

HP292 AN EXT

piantana
floor lamp
cm h. 93
LED 3.2w, 410 lm,
3000K
IP65



HP292 BN EXT

piantana
floor lamp
cm h. 118
LED 3.2w, 410 lm,
3000K
IP65



HP292 CN EXT

piantana
floor lamp
cm h. 158
LED 3.2w, 410 lm,
3000K
IP65





POIS
design
matteo ugolini







POIS
design
matteo ugolini





POIS
design
matteo ugolini



ABACHINA

design edmondo testaguzza

Piccole sfere di vetro soffiato, ancorate alla struttura metallica a parallelepipedo, rimandano ad un'attività ludica e allo scorrere delle palline sul pallottoliere.

Little spheres of blown glass, secured to a rectangular metal frame, a reference to games, reminiscent of beads sliding along an abacus.





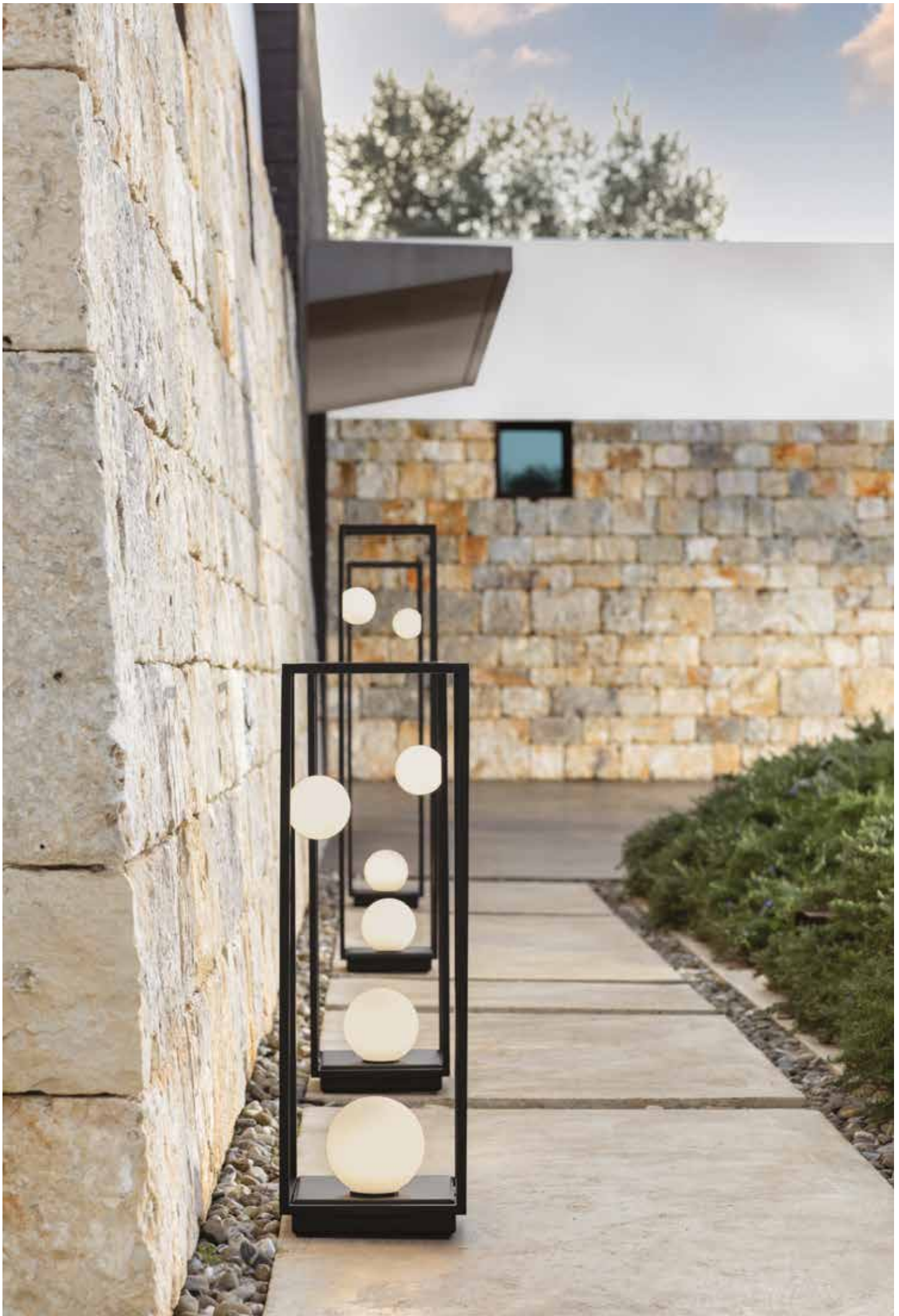

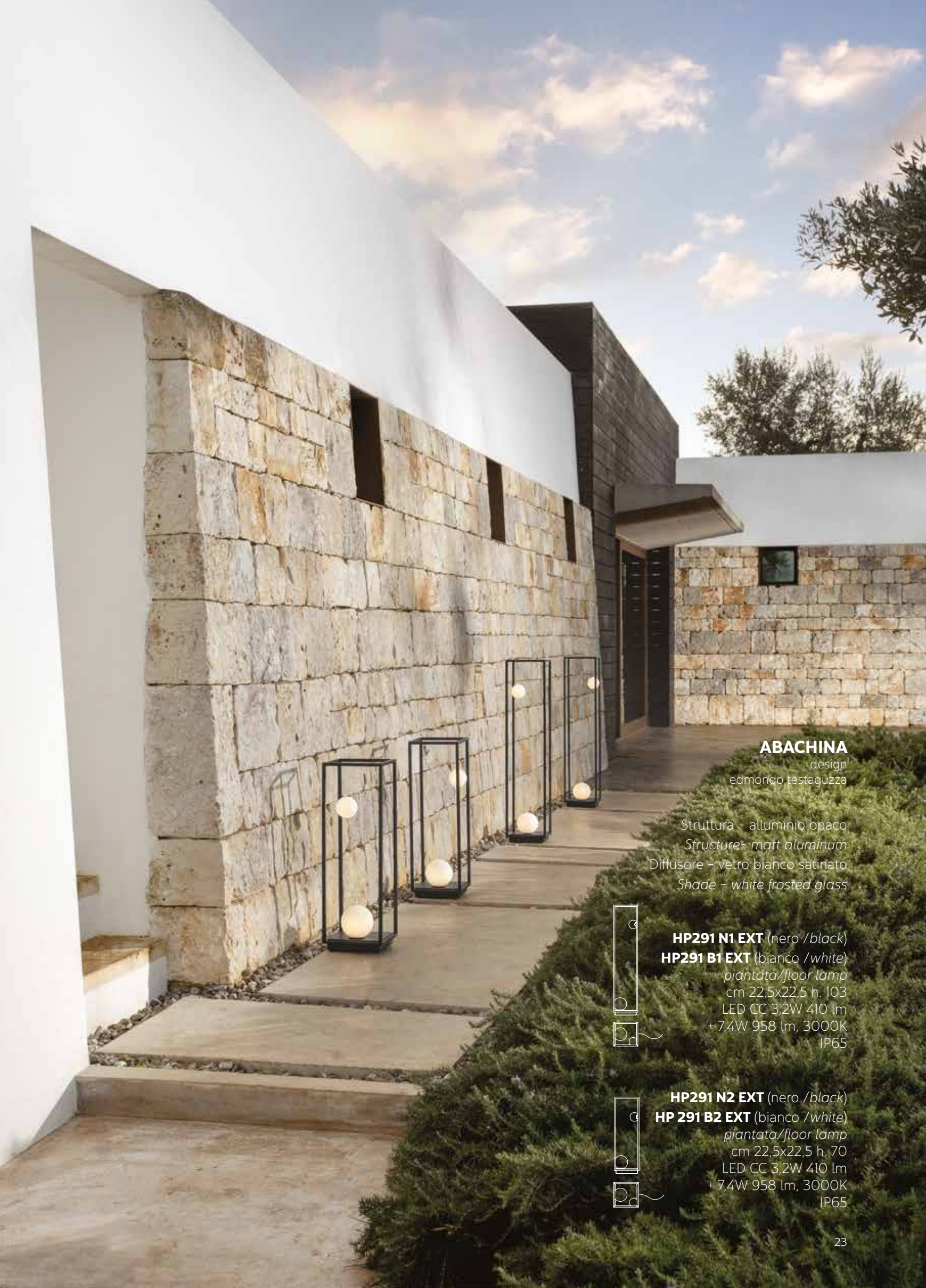

ABACHINA

design
edmondo testaguzza

Struttura - alluminio opaco
Structure- matt aluminum
Diffusore - vetro bianco satinato
Shade - white frosted glass



HP291 N1 EXT (nero /black)
HP291 B1 EXT (bianco /white)
piantata/floor lamp
cm 22,5x22,5 h. 103
LED CC 3,2W 410 lm
+ 7,4W 958 lm, 3000K
IP65



HP291 N2 EXT (nero /black)
HP 291 B2 EXT (bianco /white)
piantata/floor lamp
cm 22,5x22,5 h. 70
LED CC 3,2W 410 lm
+ 7,4W 958 lm, 3000K
IP65

ABACHINA
design
edmondo testaguzza





ABACHINA

design
edmondo testaguzza







ABACHINA

design
edmondo testaguzza

Struttura - alluminio opaco
Structure - matt aluminum
Diffusore - vetro bianco satinato
Shade - white frosted glass

HP291 N3 INT (nero/black)
HP291 B3 INT (bianco/white)
piantata
floor lamp
cm 22,5x22,5 h. 103
LED CC 2,6W 360 lm,
rechargeable batteries 5V
3000K



HP 291 N4 INT (nero/black)
HP 291 B4 INT (bianco/white)
piantata
floor lamp
cm 22,5x22,5 h. 70
LED CC 2,6W 360 lm,
rechargeable batteries 5V
3000K



Accessorio - vassoio
Optional - tray

AC 291 N1 EXT (nero/black)
AC 291 B1 EXT (bianco/white)



ABACHINA

design
edmondo testaguzza

Struttura - alluminio opaco

Structure - matt aluminum

Diffusore - vetro bianco satinato

Shade - white frosted glass

AP291 N1 EXT (nero/black)

AP291 B1 EXT (bianco/white)

applique

wall lamp

cm 14x16 h. 32

LED CC 3,2W 410 lm

3000K

IP44

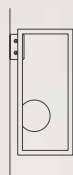



ABACHINA

design
edmondo testaguzza



Struttura - alluminio nero opaco
Structure - matt black aluminum
Diffusore - vetro bianco satinato
Shade - white frosted glass

AP291 N1 EXT

*applique
wall lamp*
cm 14x16 h. 32
LED CC 3,2W 410 lm
3000K
IP44





ABACHINA
design
edmondo testaguzza

Struttura - alluminio bianco opaco
Structure - matt white aluminum
Diffusore - vetro bianco satinato
Shade - white frosted glass

AP291 B1 EXT
applique
wall lamp
cm 14x16 h. 32
LED CC 3,2W 410 lm
3000K
IP44

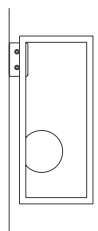



ABACHINA

design
edmondo testaguzza

Struttura - alluminio opaco
Structure - matt aluminum
Diffusore - vetro bianco satinato
Shade - white frosted glass

HP 291 B1 INT (bianco/white)

HP 291 N1 INT (nero/black)

piantata

floor lamp

cm 22,5x22,5 h. 103

LED CC 3,2W 410 lm

+ 7,4W 958 lm

3000K

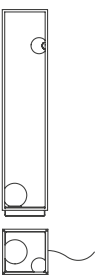

HP 291 B2 INT (bianco/white)

HP 291 N2 INT (nero/black)

piantata

floor lamp

cm 22,5x22,5 h. 70

LED CC 3,2W 410 lm

+ 7,4W 958 lm

3000K

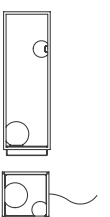



L

E

Leda

design debonademeo

Leda, il led al femminile. Il mito di Leda e il Cigno rivive in un inedito incontro tra poesia e tecnologia. Una collana luminosa composta da sfere e cilindri in alluminio anodizzato e da un diffusore flessibile che consente molteplici conformazioni in ambienti sia interni che esterni. Una piccola asola di metallo permette di definire a piacere la disposizione e la forma.

Leda, a Led with a feminine touch. The myth of Leda and the Swan is back in a brand new encounter of poetry and technology. A necklace of light composed of spheres and cylinders in anodized aluminium and with a flexible diffuser that lends itself to a variety of arrangements in both indoor and outdoor spaces. A small metal slot allows you to change the layout and shape of your choice.

DA





LEDA
design
debonademeo

Struttura - alluminio opaco
Structure - matt aluminum
Diffusore - silicone bianco opaco
Shade - matt white silicone

SE293BNINT (nero/black)
SE293BOINT (bronzo/bronze)
sospensione
pendant
cm 100 x 300 (max) Ø 2,3
LED 24V, 14,4W, 922 lm, 3000K





LEDA

design
debonademeo

Struttura - alluminio opaco
Structure - matt aluminum
Diffusore - silicone bianco opaco
Shade - matt white silicone

SE 293 EN INT (nero/black)
SE 293 EO INT (bronz/bronze)
sospensione
pendant
3000K







LEDA

design
debonademeo

Struttura - alluminio opaco
Structure - matt aluminum
Diffusore - silicone bianco opaco
Shade - matt white silicone

SE 293 CN INT (nero/black)
SE 293 CO INT (bronzo/bronze)
sospensione
pendant
3000K

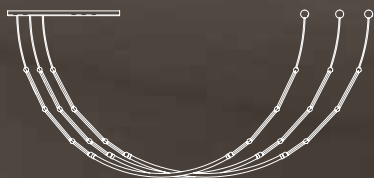

LEDA

design
debonademeo

Struttura - alluminio opaco
Structure - matt aluminum
Diffusore - silicone bianco opaco
Shade - matt white silicone

SE 293 DN INT (nero/black)
SE 293 DO INT (bronzo/bronze)
sospensione
pendant
3000K



LEDA
design
debonademeo

Struttura - alluminio opaco
Structure - matt aluminum
Diffusore - silicone bianco opaco
Shade - matt white silicone

SE293 AN INT (nero/black)
SE293 AO INT (bronzo/bronze)
sospensione
pendant
cm 100 x 300 (max) Ø 2,3
LED 24V, 14,4W, 922 lm,
3000K



LEDA

design
debonademeo

Struttura - alluminio opaco
Structure - matt aluminum
Diffusore - silicone bianco opaco
Shade - matt white silicone

SE293 BN EXT (nero/black)
SE293 BO EXT (bronzo/bronze)
sospensione
pendant
cm 100x300 (max) Ø 2,3
LED 24V, 14,4W, 922 lm,
3000K
IP65

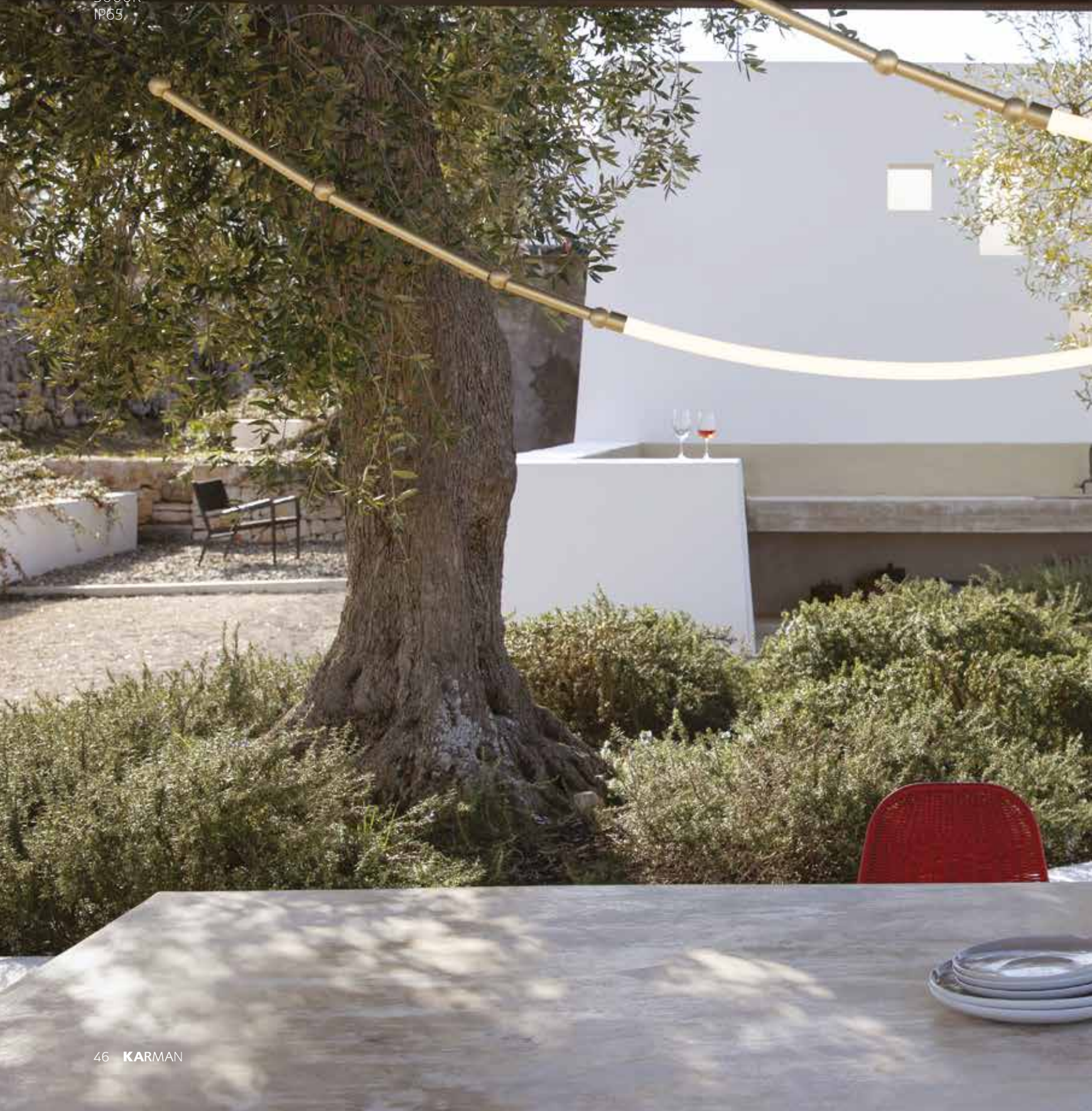



LEDA

design
debonademeo

Struttura - alluminio opaco
Structure - matt aluminum
Diffusore - silicone bianco opaco
Shade - matt white silicone

HP293AN INT (nero/black)
HP293AO INT (bronzo/bronze)
cielo-terra
hanging floor lamp
cm 100 x 300 (max) Ø 2,3
LED 24V, 14,4W, 922 lm,
3000K







LEDA

design
debonademeo

Struttura - alluminio opaco
Structure - matt aluminum
Diffusore - silicone bianco opaco
Shade - matt white silicone

SE293 AO EXT (bronzo/bronze)
SE293 AN EXT (nero/black)

sospensione
pendant
cm 100 x 300 (max) Ø 2,3
LED 24V, 14,4W, 922 lm,
3000K
IP65

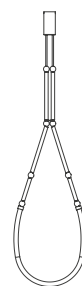



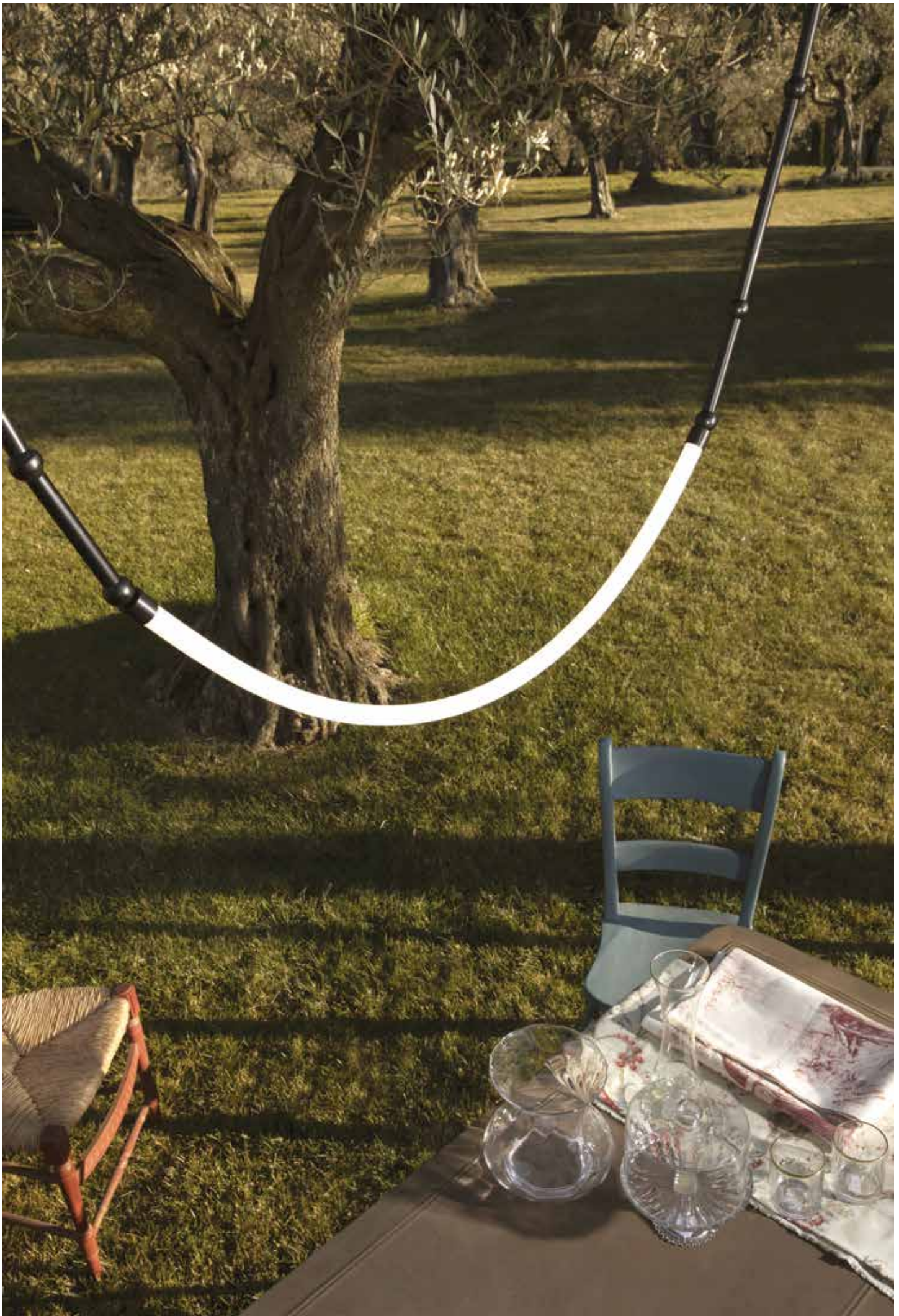



LEDA

design
debonademeo

Struttura - alluminio opaco

Structure - matt aluminum

Diffusore - silicone bianco opaco

Shade - matt white silicone

SE293 N1 EXT (nero/black)

SE293 O1 EXT (bronzo/bronze)

sospensione

pendant

cm 100x300 (max) Ø 2,3

LED 24V, 14,4W, 922 lm,

3000K

IP65



Agua

design matteo ugolini & edmondo testaguzza

Costellazioni geometriche volteggiano infinite sopra di noi. Come una goccia di rugiada pura e trasparente che riflette la luce dell'alba dopo una notte serena, Agua fluttua con leggerezza impercettibile, come i sogni al mattino.

Geometric constellations fly in infinite circles above us. Like a pure, clear dewdrop reflecting the light of the dawn after a calm night, Agua floats with an imperceptible lightness, like dreams in the morning.

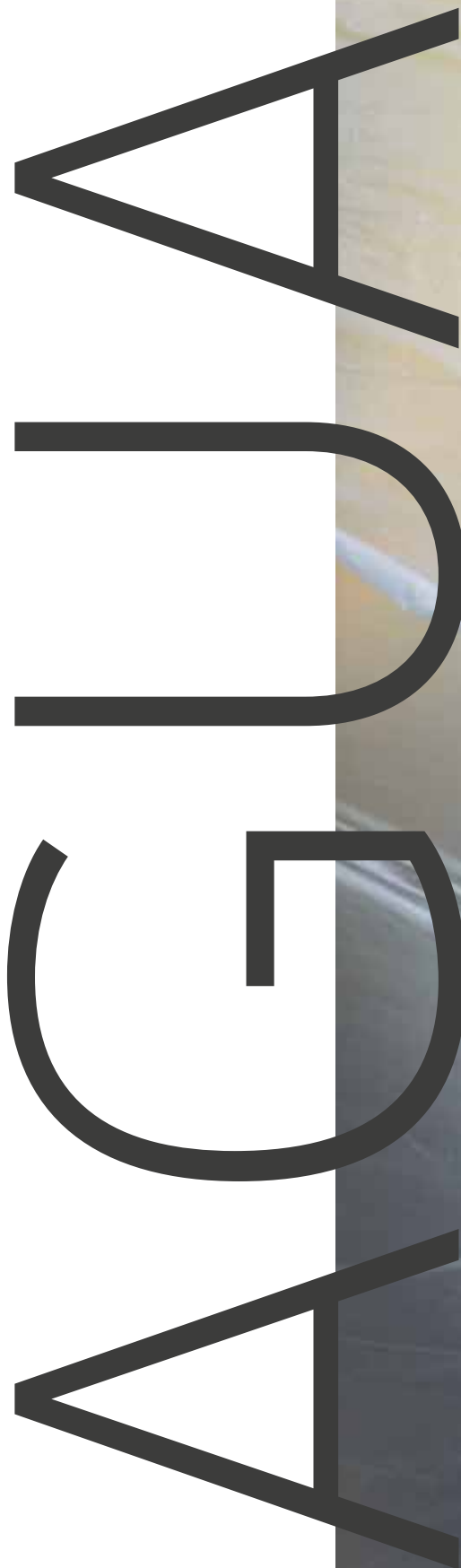
The word 'AGUA' is written in a large, bold, black, sans-serif font, oriented vertically. The letters are positioned on the left side of a vertical line that separates a white background from a background of water ripples. The water ripples are in shades of light blue and grey, creating a textured, organic feel. The overall composition is minimalist and modern.

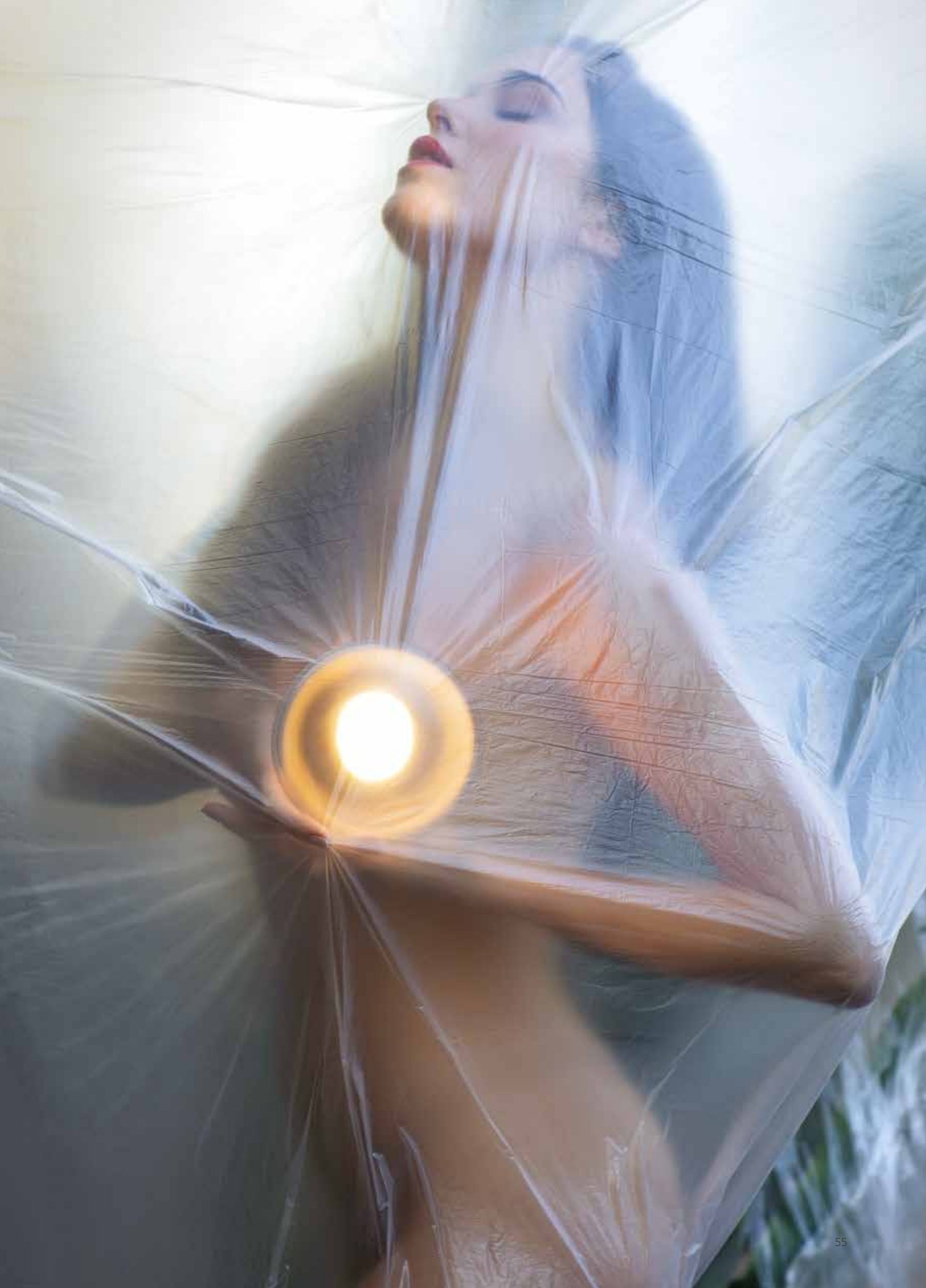



AGUA

design
matteo ugolini
edmondo testaguzza

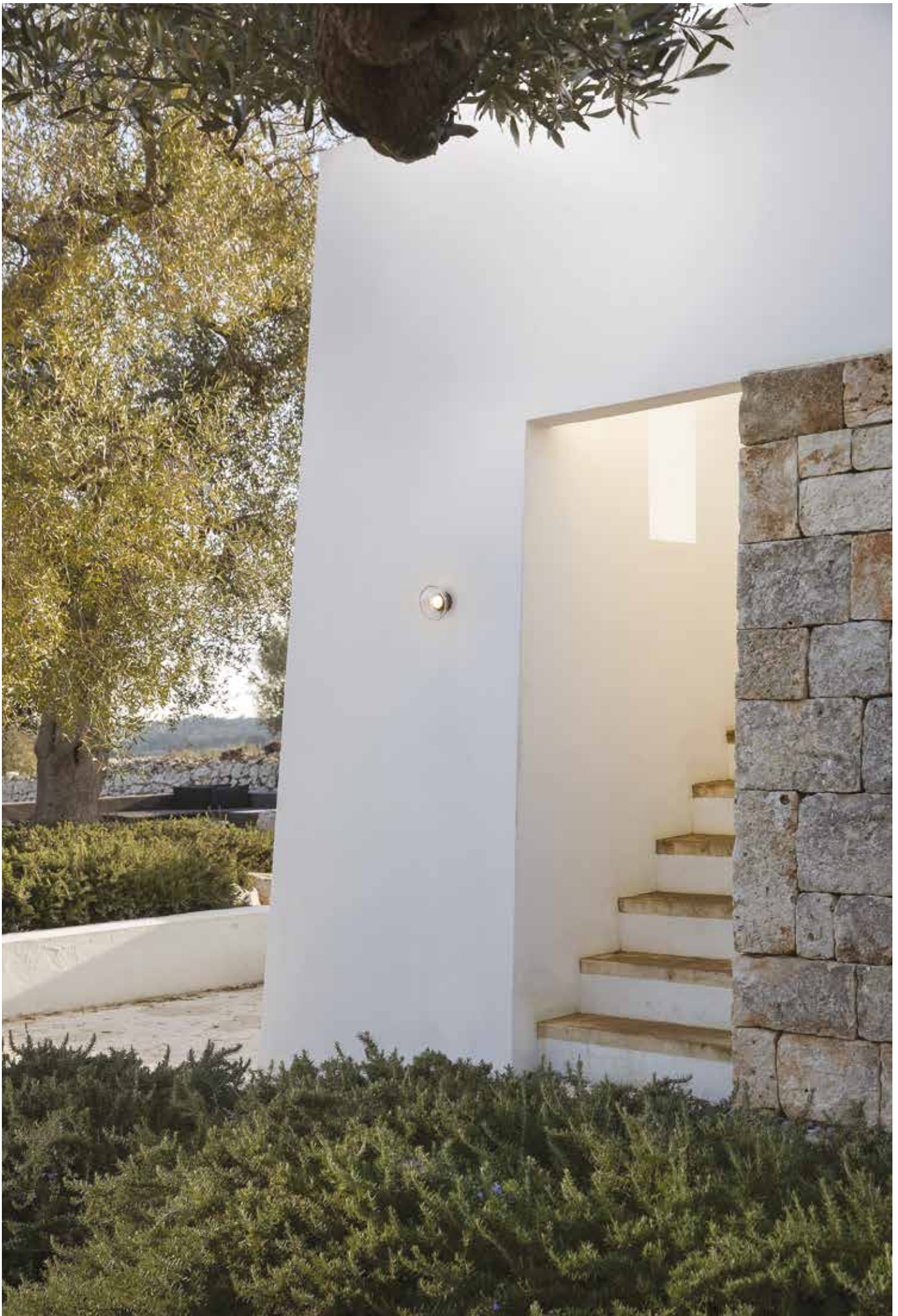

AGUA

design
matteo ugolini
edmondo testaguzza

Struttura in alluminio nero opaco
Structure in matt black aluminum
Diffusore in vetro
Shade in glass

AP290 T1 EXT (trasparente/transparent)
AP290 S1 EXT (acidato/frosted)
applique
wall lamp
cm 13 x 9
LED CC 350mA,
3,2W, 410 lm 3000K
IP44

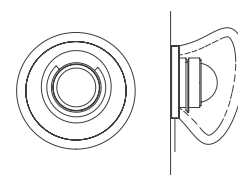





AGUA

design
matteo ugolini
edmondo testaguzza

Struttura in alluminio nero opaco
Structure in matt black aluminum
Diffusore in vetro trasparente
Shade in transparent glass

CT290 T1 INT

lampada da tavolo
table lamp
cm 13 x 9
LED CC 350mA, 3,2W,
410 lm, 3000K





AGUA

design
matteo ugolini
edmondo testaguzza

Struttura in alluminio nero opaco
Structure in matt black aluminum
Diffusore in vetro acidato
Shade in frosted glass

CT290 S1 INT

lampada da tavolo
table lamp
cm 13 x 9
LED CC 350mA, 3,2W,
410 lm, 3000K

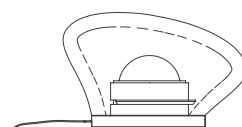







AGUA
design
matteo ugolini
edmondo testaguzza



AGUA

design

matteo ugolini

edmondo testaguzza



AGUA

design
matteo ugolini
edmondo testaguzza

Struttura in alluminio nero opaco
Structure in matt black aluminum
Diffusore in vetro
Shade in glass

AP290 T1 EXT (trasparente/transparent)

AP290 S1 EXT (acidato/frosted)

applique
wall lamp
cm 13 x 9
LED CC 350mA,
3,2W, 410 lm 3000K
IP44

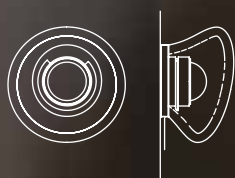





AGUA
design
matteo ugolini
edmondo testaguzza



“La fine di un amore di plastica...”

“The end of a plastic love...”



Concept / matteo ugolini

Photo / factory snc

Layout / adv media lab

Print / stibu

© KARMAN 2022

Karman srl
via Grandi, 10/s
61034 Fossombrone PU - Italy
phone +39 0721 715042 r.a.
info@karmanitalia.it
www.karmanitalia.it

